

I-330 only
 Description
 eg. 19.25 ch S. N. W. cor. - S 20.75 ch E 4.64 ch blue lat. Hooper & Piche - N 1/2 E 20.70
 mid st. & 6' long. 9.75 ch (I-331 - June 12-1874 Hooper to P. Quirk - above description)
 J-370 - P. Quirk to Jas. Wilson Nov 27-1875 - same land above described
 K 244 - Nov 24-1876 - Jas Wilson to Arthur Skellington same land above described

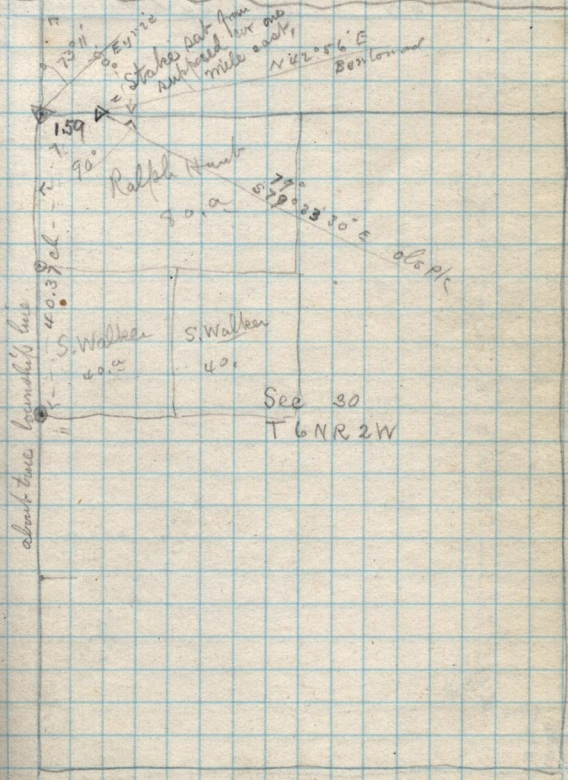

73.11
 50° Eyrie
 Stakes set from
 supposed for one
 mile east
 N 42° 56' E
 Ben Leonard
 159
 90°
 Ralph Hunt
 30.2
 S 29° 23' 30" E
 40.39 ch
 S. Walker
 40.2
 S. Walker
 40.

See 30
 T 6 N R 2 W